

Colonial, Detached - LIGNUM, VA



Lot 3B Beaver Creek Court, Lignum, VA, 22726

Offered at \$574,000

TO BE BUILT - MOSBY MODEL on 10 acres. Home will include stainless steel appliances and granite countertops in kitchen, master bathroom with double vanity sinks and walk-in shower; Large covered front porch on the front, unfinished basement with bathroom rough in, and 2 car garage. Other upgrades are available. There is still time to make your selections. Call for more information.

3 Bedrooms
3 Bathrooms
1,760 sqft
10.05 acre (lot size)
Built: 2022

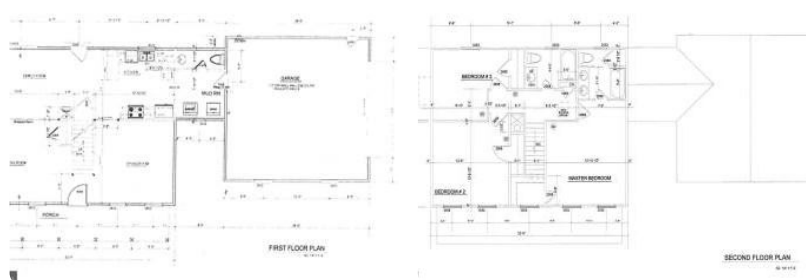

Scan above on mobile device
for directions to this listing

Assist2Sell
vip@assist2sell.com



All information deemed reliable but not guaranteed. If your property is currently listed this is not meant as a solicitation.
©2025 Assist2Sell.com - Licensed according to agreed upon terms and conditions. This listing is courtesy of Century 21 New Millennium

