

# Single Family Residence, Craftsman - Pottsboro, TX



## Lot 11 Whispering Meadow Boulevard, Pottsboro, TX, 75076

Offered at \$419,710

This designer build home will be built in the gated community of Whispering Meadows Estates. Located jut outside the city limits, is is only 1 mile from the lake and a short drive to town. Standard building specifications include all of the finishes you've come to expect in today's Craftsman home. Gorgeous cabinetry, solid surface countertops, hardwood floors, and luxurious tile schemes adorn this home. Go under contract before construction and you can pick your own colors for your siding, roof, kitchen cabinets along with tile, paint, and wood floors. Anything not specifically listed here as standard is option and at extra cost to the buyer.

3 Bedrooms
2 Bathrooms
1,786 sqft
0.28 acre (lot size)
Built: 2022

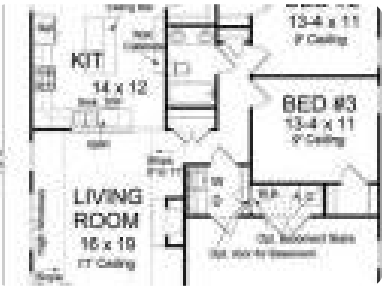

Assist2Sell

No other photos  
Available

Assist2Sell

No other photos  
Available



Scan above on mobile device  
for directions to this listing

Assist2Sell  
vip@assist2sell.com



All information deemed reliable but not guaranteed. If your property is currently listed this is not meant as a solicitation.  
©2025 Assist2Sell.com - Licensed according to agreed upon terms and conditions. This listing is courtesy of Easy Life Realty

