

Vacant land - GAITHERSBURG, MD

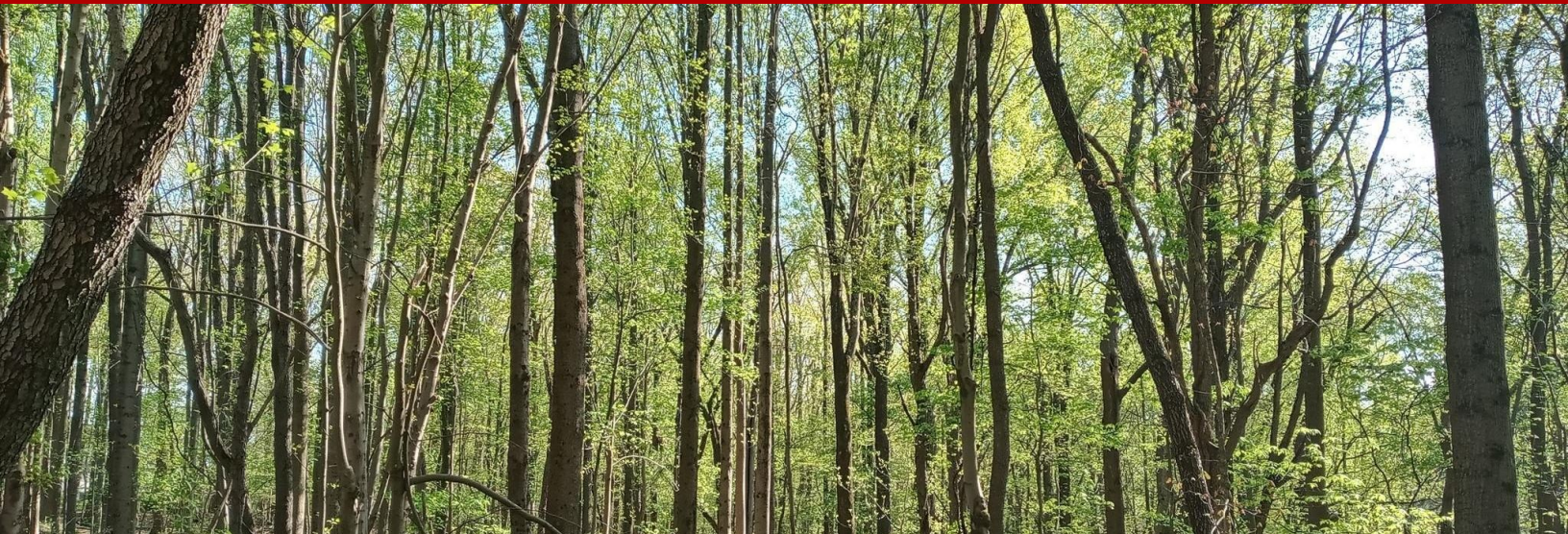

8218 Seneca View Drive, Gaithersburg, MD, 20882

Offered at \$999,000

Are you looking for four buildable lot sites perfect for luxury, secluded-feeling, forest-nestled home lots? The Enchanted Forest of Damascus, MD will give your home buyers a tranquil forest view when they come home to your luxury-built homes. Water table tests are complete, the Concept Plan Meeting offered completed, engineering sketches are attached, environmental study, NRI-FSD submitted to County and should be approved in August. PERCs to be done during due diligence or in August by the owner. Two out-lot parcels come with these 22 acres and provide the necessary frontage for 4-lot subdivision. The cluster design provides a permanent forest preserve right outside their front door, which your homeowners will own and satisfies the rural zoning requirements. Excellent neighborhood! Will likely require Cul de Sac and/or T turn-around for emergency access.

0 Bedrooms
0 Bathrooms
Unknown sqft sqft
22.25 acre (lot size)
Built: Unknown year

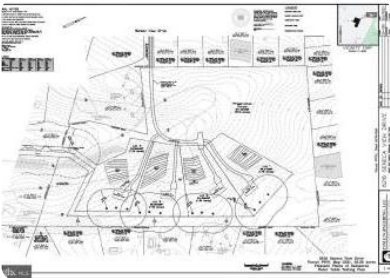

Scan above on mobile device
for directions to this listing

Assist2Sell
vip@assist2sell.com



All information deemed reliable but not guaranteed. If your property is currently listed this is not meant as a solicitation.
©2025 Assist2Sell.com - Licensed according to agreed upon terms and conditions. This listing is courtesy of Taylor Properties

