

Vacant land - LAUREL, MD

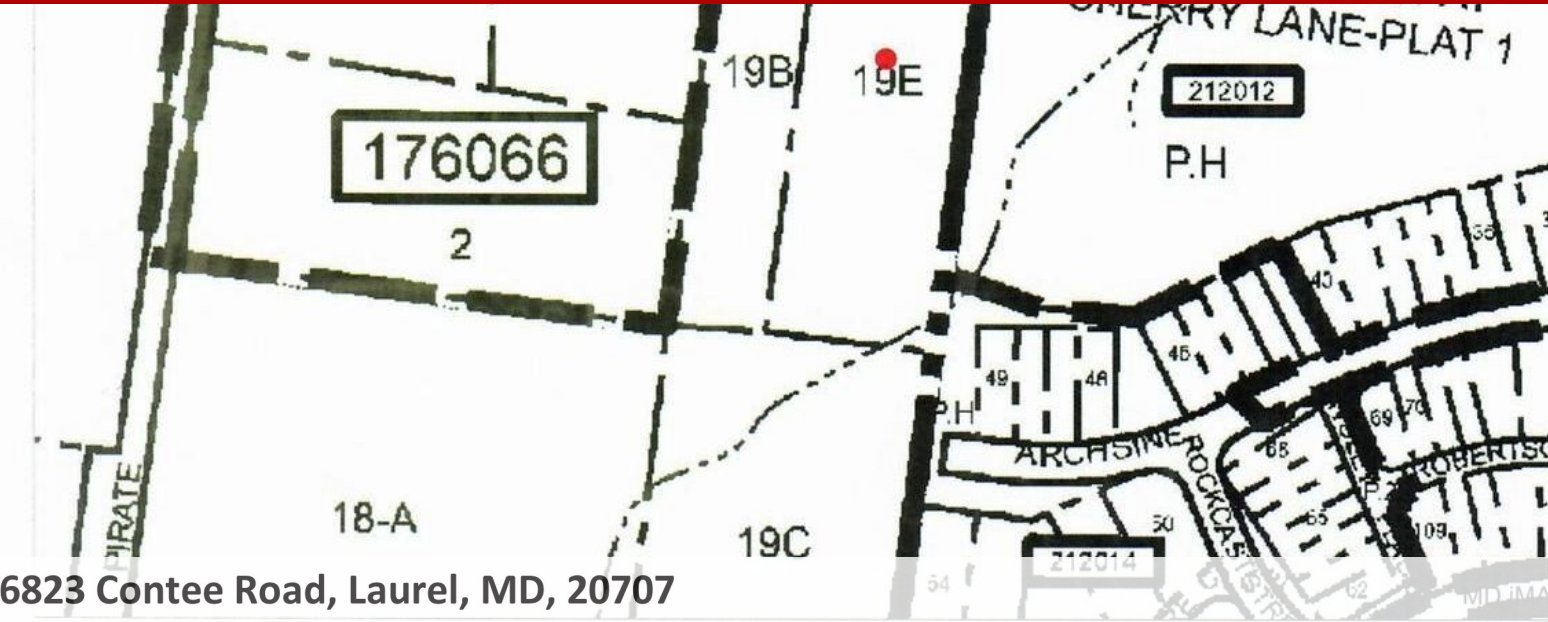

6823 Contee Road, Laurel, MD, 20707

Offered at \$480,000

Incredible builder/developer opportunity on a total of 1.32 acres on this piece. For annexing into the city of Laurel for townhouse zoning or multifamily use. Possible larger parcels may be made available as well. Houses are being sold AS IS and are not available to be seen because the main value is in the land. There is tons of potential here! Total acreage available with other listings is 6.84 acres. 6825 Contee Rd, 7100 Cherry Ln & 7202 Cherry Ln. SDAT Map for all 4 Properties in Documents for Buyers & Agents information. Public Water and Sewer hook up with city o Laurel annexing. See 19-E on owners drawing for location.

0 Bedrooms
0 Bathrooms
Unknown sqft sqft
1.32 acre (lot size)
Built: Unknown year



Assist2Sell

No other photos
Available

Assist2Sell

No other photos
Available

Assist2Sell

No other photos
Available



Scan above on mobile device
for directions to this listing

Assist2Sell
vip@assist2sell.com

