

Land - Newfields, NH



65 Newmarket Road, Newfields, NH, 03856

Offered at \$659,000

This site is one of the most heavily trafficked areas in Newfields, abutting a Dunkin' Donuts and across from a gas station. The Dunkin' Donuts is one of the highest performing Dunkin sites in the seacoast. With so few commercial options in the area, this site is ideal for development. This site on Route 108 is less than 1/2 mile from Route 85 & 33, centrally located on the southwest side of the Great Bay. Owner is selling the land and improvements to the land, which include survey, engineering, and previously approved plans for commercial development, which have previously lapsed. Those approvals had nearly 8000 SF of space approved. The traffic counts are over 18,000, and both morning and evening are very busy.

0 Bedrooms
0 Bathrooms
Unknown sqft sqft
2 acre (lot size)
Built: Unknown year

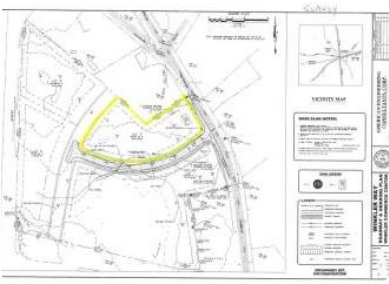

Scan above on mobile device
for directions to this listing

Assist2Sell
vip@assist2sell.com



All information deemed reliable but not guaranteed. If your property is currently listed this is not meant as a solicitation.
©2025 Assist2Sell.com - Licensed according to agreed upon terms and conditions. This listing is courtesy of keller williams coastal realty

