

Land - Auburn, ME



41 Mystique Way, Auburn, ME, 04210

Offered at \$199,000

Industrial Subdivision consisting of 7 total commercial approved land parcels to construct buildings. Utilities stubbed to each site. Lot sales starting at \$199,900 or land lease with purchase option. Site allows for new building up to 11,500 sq ft.

0 Bedrooms
0 Bathrooms
Unknown sqft sqft
1.2 acre (lot size)
Built: Unknown year

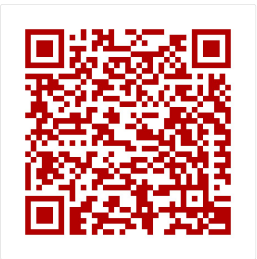
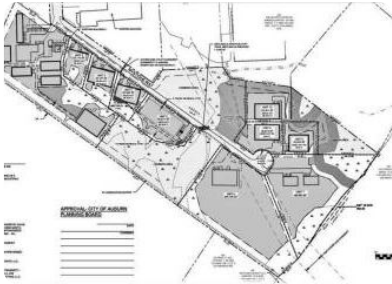

Scan above on mobile device
for directions to this listing

Assist2Sell
vip@assist2sell.com



All information deemed reliable but not guaranteed. If your property is currently listed this is not meant as a solicitation.
©2026 Assist2Sell.com - Licensed according to agreed upon terms and conditions. This listing is courtesy of Keller Williams Realty

