

Unimproved Land - Cleburne, TX

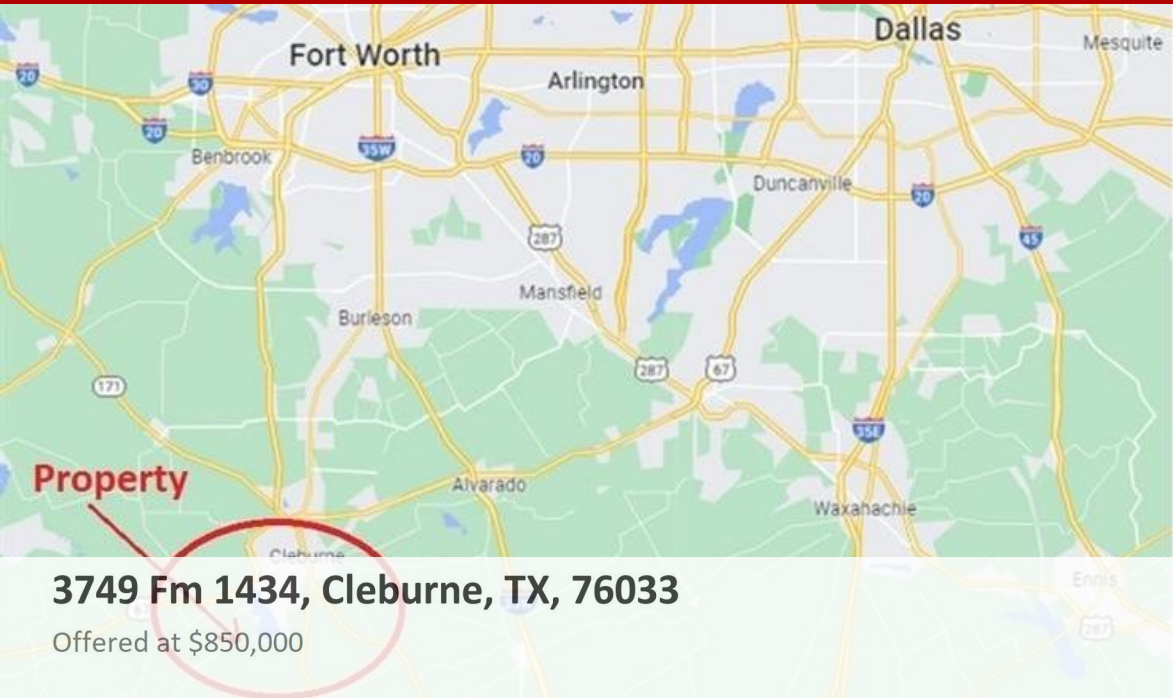

3749 Fm 1434, Cleburne, TX, 76033

Offered at \$850,000

Ideal for Housing Development, Investment, Building your Country Home, or Locating your Business or Industry just outside Cleburne's city limit. This land is on the main road of FM 1434 and within 2 minutes from Cleburne Lake's public access, 5 minutes from the main Cleburne Hospital, 7 minutes from Walmart, and 8 minutes from Chisolm Trail Parkway. Cherish this land's natural spring and Ag Exemption status while enjoying tranquility and proximity to civilization.

0 Bedrooms
0 Bathrooms
Unknown sqft sqft
35 acre (lot size)
Built: Unknown year



Scan above on mobile device
for directions to this listing

Assist2Sell
vip@assist2sell.com

Assist2Sell.

All information deemed reliable but not guaranteed. If your property is currently listed this is not meant as a solicitation.
©2026 Assist2Sell.com - Licensed according to agreed upon terms and conditions. This listing is courtesy of Ready Real Estate, LLC

