

Residential - Vernal, UT

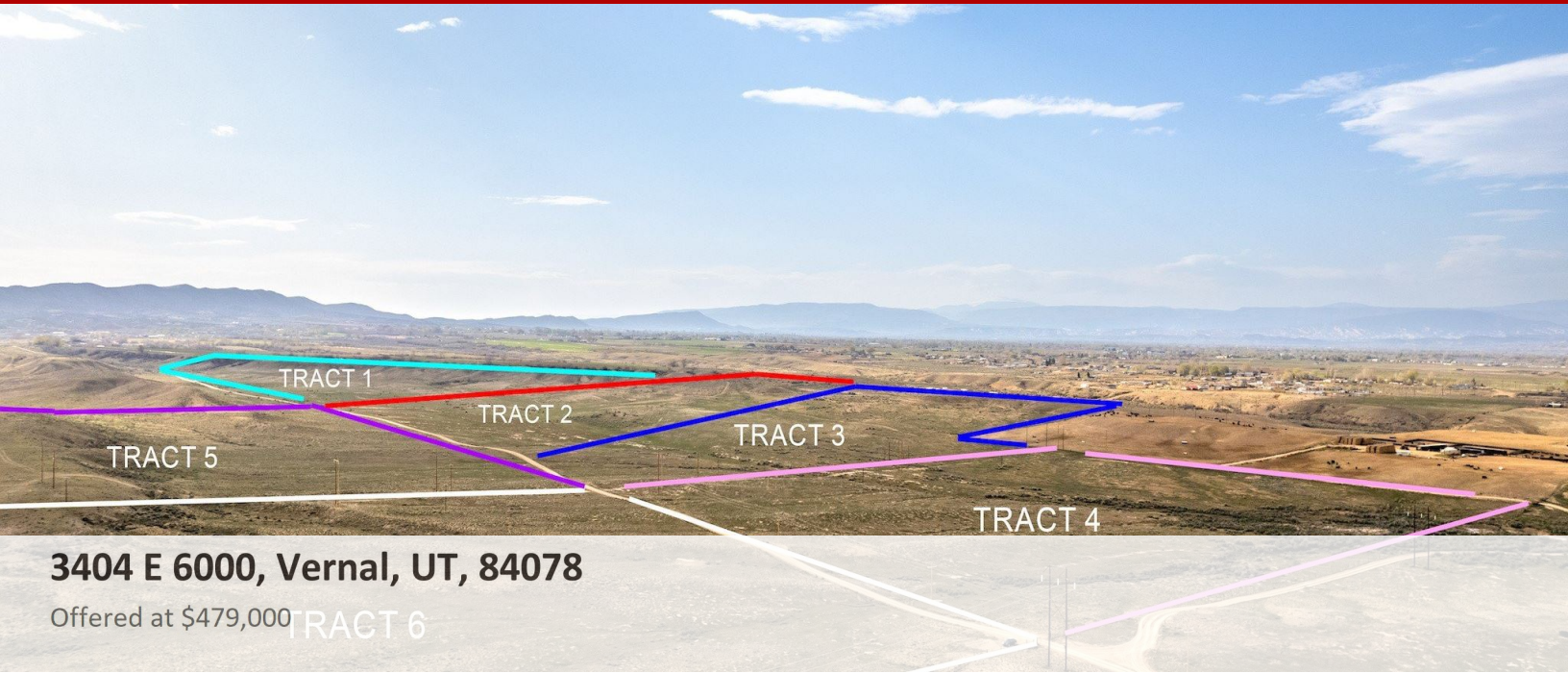

3404 E 6000, Vernal, UT, 84078

Offered at \$479,000

Track 6 on photos. Zoned residential, agriculture, & mining. Would make a great Gravel Pit yet buyer to determine. Can be purchased with the other 5 plats as well especially would work with track 5. Recent survey and appraisal has been completed. Vacant Land. Drive by and show.

0 Bedrooms
0 Bathrooms
Unknown sqft sqft
33.75 acre (lot size)
Built: Unknown year



Scan above on mobile device
for directions to this listing

Assist2Sell
vip@assist2sell.com



All information deemed reliable but not guaranteed. If your property is currently listed this is not meant as a solicitation.
©2026 Assist2Sell.com - Licensed according to agreed upon terms and conditions. This listing is courtesy of Keller Williams Westfield Real Estate

