

Residential - Vernal, UT

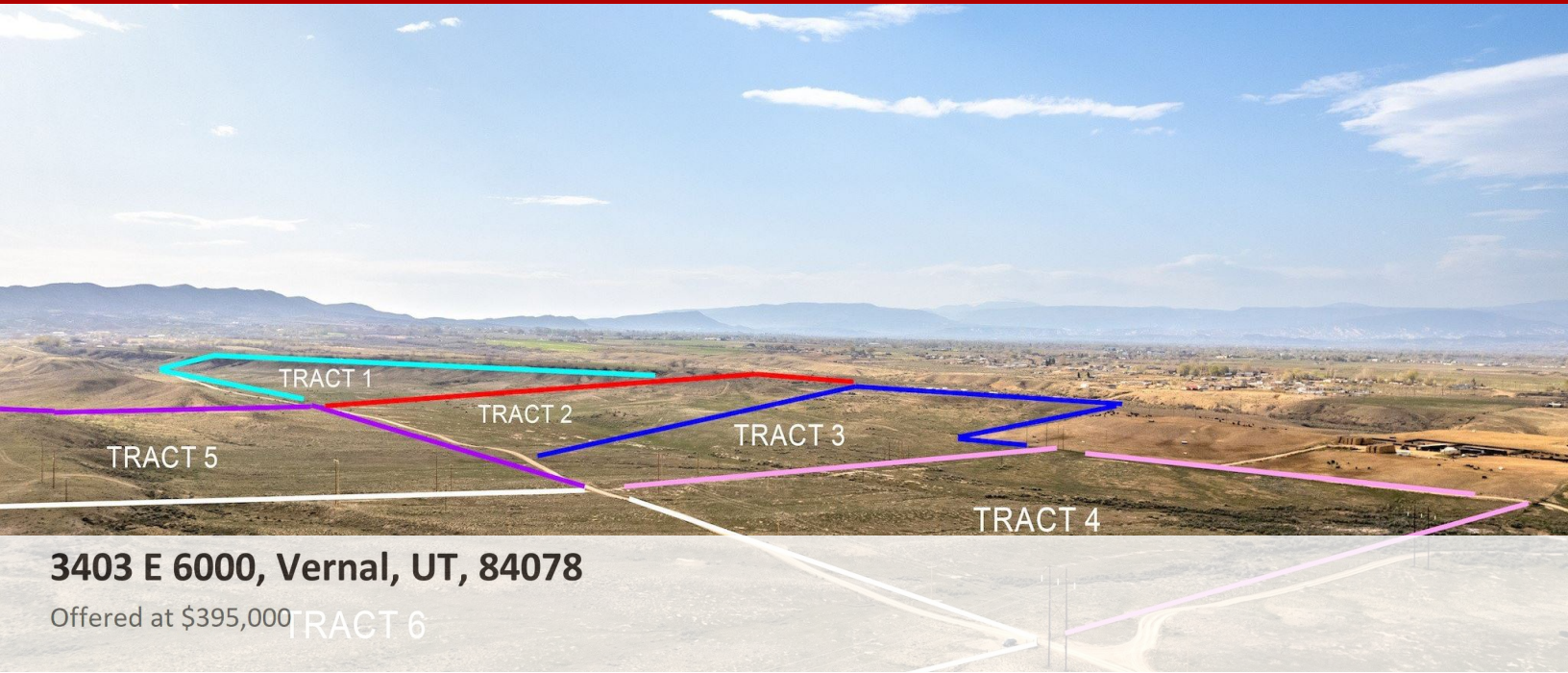

3403 E 6000, Vernal, UT, 84078

Offered at \$395,000

Track 4 on photos. Can be purchased with the other 5 plats. Recent Survey and appraisal has been completed. Vacant Land. Drive by and show.

0 Bedrooms
0 Bathrooms
Unknown sqft sqft
33.95 acre (lot size)
Built: Unknown year



Scan above on mobile device
for directions to this listing

Assist2Sell
vip@assist2sell.com



All information deemed reliable but not guaranteed. If your property is currently listed this is not meant as a solicitation.
©2026 Assist2Sell.com - Licensed according to agreed upon terms and conditions. This listing is courtesy of Keller Williams Westfield Real Estate



<https://assist2sell.com/listing/3403-e-6000-vernal-ut-84078/3yd-wfrmlsut-1810650>