

# Residential - Vernal, UT

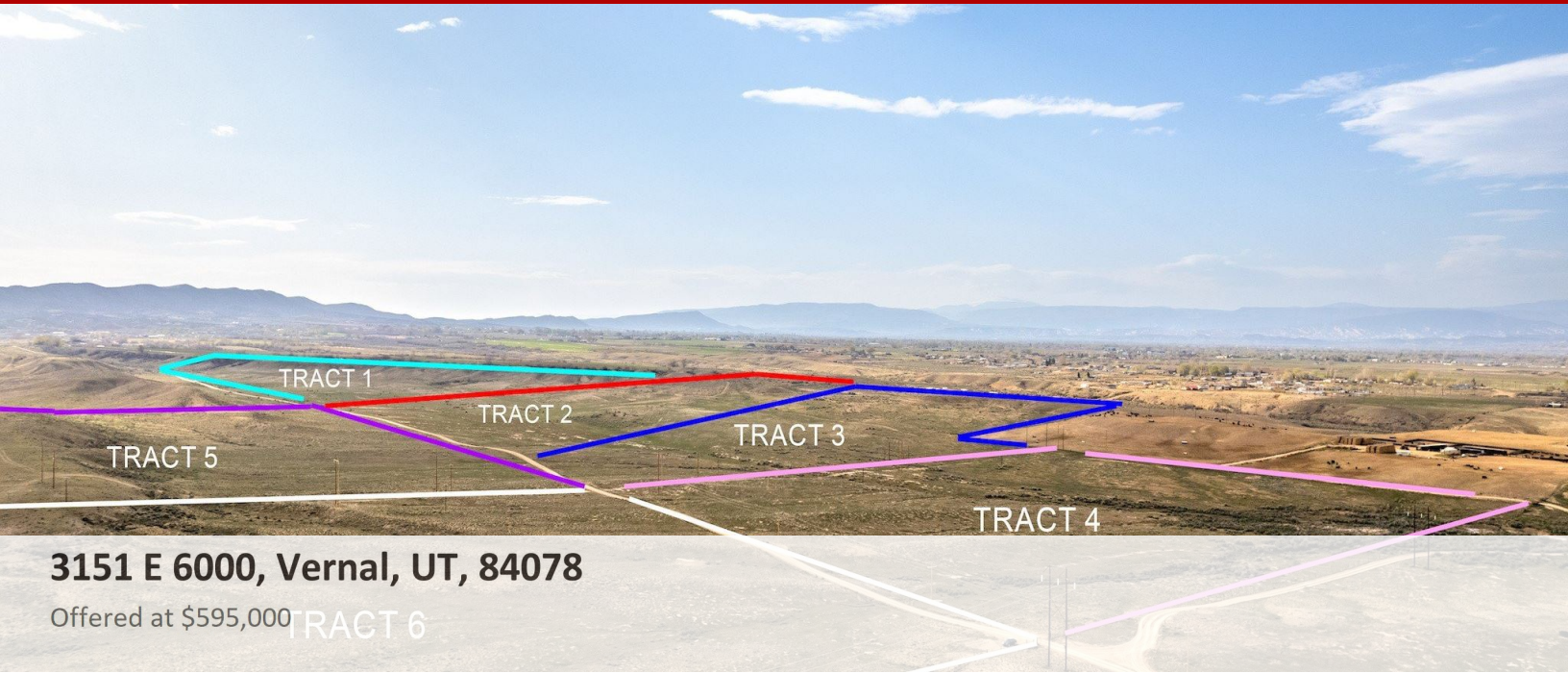

3151 E 6000, Vernal, UT, 84078

Offered at \$595,000

Track 2 on photos. Top of plat 2 and 3 both touch a cul-de-sac. Can be purchased with the other 5 plats. Recent Survey and appraisal has been completed. Vacant Land. Drive by and show!

0 Bedrooms
0 Bathrooms
Unknown sqft sqft
36.18 acre (lot size)
Built: Unknown year



Scan above on mobile device  
for directions to this listing

Assist2Sell  
vip@assist2sell.com



All information deemed reliable but not guaranteed. If your property is currently listed this is not meant as a solicitation.  
©2025 Assist2Sell.com - Licensed according to agreed upon terms and conditions. This listing is courtesy of Keller Williams Westfield Real Estate

