





Ranch, 1 Story, Single Family - Hartsville, SC



310 W Home Ave, Hartsville, SC, 29550

Offered at \$295,000

Location, Location, Location! 2 blocks from thriving Downtown Hartsville, 1 block from the library, restaurants, wine bars, and fantastic shopping. All original wood floors were just refinished in June, kitchen was expanded and updated with hard surface counter tops and ss appliances. Master bedroom on the main floor and three bedrooms upstairs and two full baths. Beautiful coffered ceilings in den, living room and dining room. A brick terrace easily accessed from the dining room for entertaining and a large fenced backyard, too. The 400 square foot building in the backyard has electricity and has multiple uses, playhouse, she-shed, mancave, etc. The sunroom off the kitchen makes a great place for morning coffee or watching the birds in the backyard. Make this your new home.

 4 Bedrooms
 3 Bathrooms
 3,100 sqft
 0.87 acre (lot size)
 Built: 1916

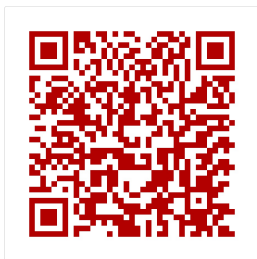
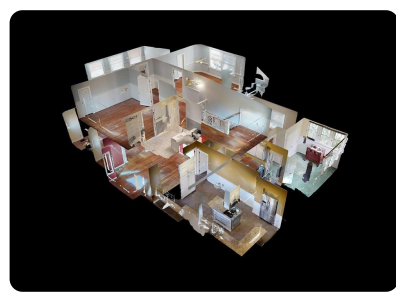

Scan above on mobile device
for directions to this listing

Assist2Sell Smart Choice Realty
(843) 667-6278
info@4florencehomes.com

Assist2Sell.

All information deemed reliable but not guaranteed. If your property is currently listed this is not meant as a solicitation.

©2019 Assist2Sell.com - Licensed according to agreed upon terms and conditions. This listing is courtesy of coldwell banker deborah gandy



<https://assist2sell.com/listing/310-w-home-ave-hartsville-sc-29550/3yd-ragpdsc-20192509>