

# Residential - Vernal, UT

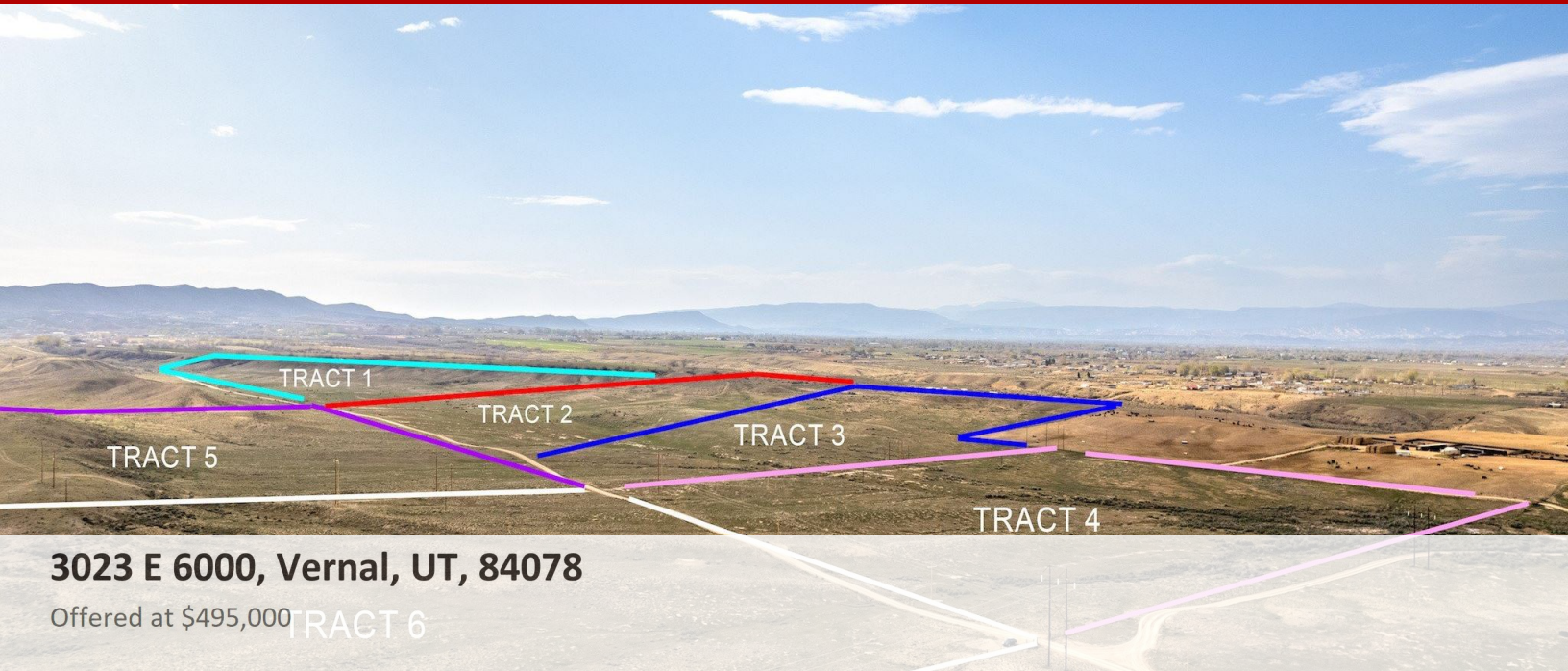

3023 E 6000, Vernal, UT, 84078

Offered at \$495,000

Track 1 on photos. Can be purchased with the other 5 plats. Recent Survey and appraisal has been completed. Vacant Land. Drive by and show!

|                     |
|---------------------|
| 0 Bedrooms          |
| 0 Bathrooms         |
| Unknown sqft sqft   |
| 39 acre (lot size)  |
| Built: Unknown year |



Scan above on mobile device  
for directions to this listing

Assist2Sell  
vip@assist2sell.com



All information deemed reliable but not guaranteed. If your property is currently listed this is not meant as a solicitation.  
©2026 Assist2Sell.com - Licensed according to agreed upon terms and conditions. This listing is courtesy of Keller Williams Westfield Real Estate

