

# LAND FOR SALE

251 Us 9, Manalapan, NJ, 07726

Offered at \$1,600,000

Prime commercial land on highly traveled Route 9 south. This 5.4 acres with ~500 ft of HWY 9 frontage offers multiple commercial use from child/adult daycare, shopping center, auto, office/medical building and much more. Property is located just prior to Taylor Mills Rd and is surrounded by successful commercial businesses. Address is 251 - 259 HWY 9s (Englishtown) per MLS geocoding.

0 Bedrooms

0 Bathrooms

Unknown sqft sqft

5.4 acre (lot size)

Built: Unknown year

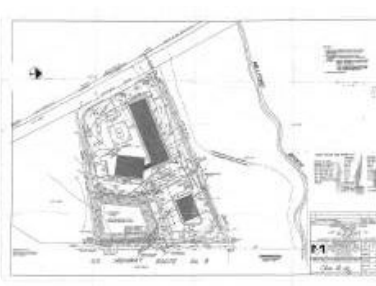
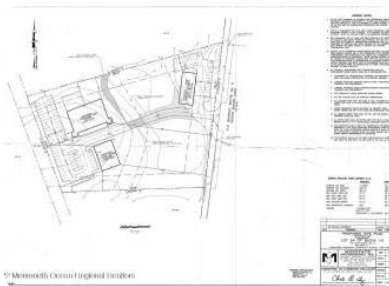

Assist2Sell

No other photos  
Available



Scan above on mobile device  
for directions to this listing

Assist2Sell  
vip@assist2sell.com

Assist2Sell

All information deemed reliable but not guaranteed. If your property is currently listed this is not meant as a solicitation.

©2025 Assist2Sell.com - Licensed according to agreed upon terms and conditions. This listing is courtesy of Preferred Properties Real Estate

