

Condominium, Other - Kyle, TX

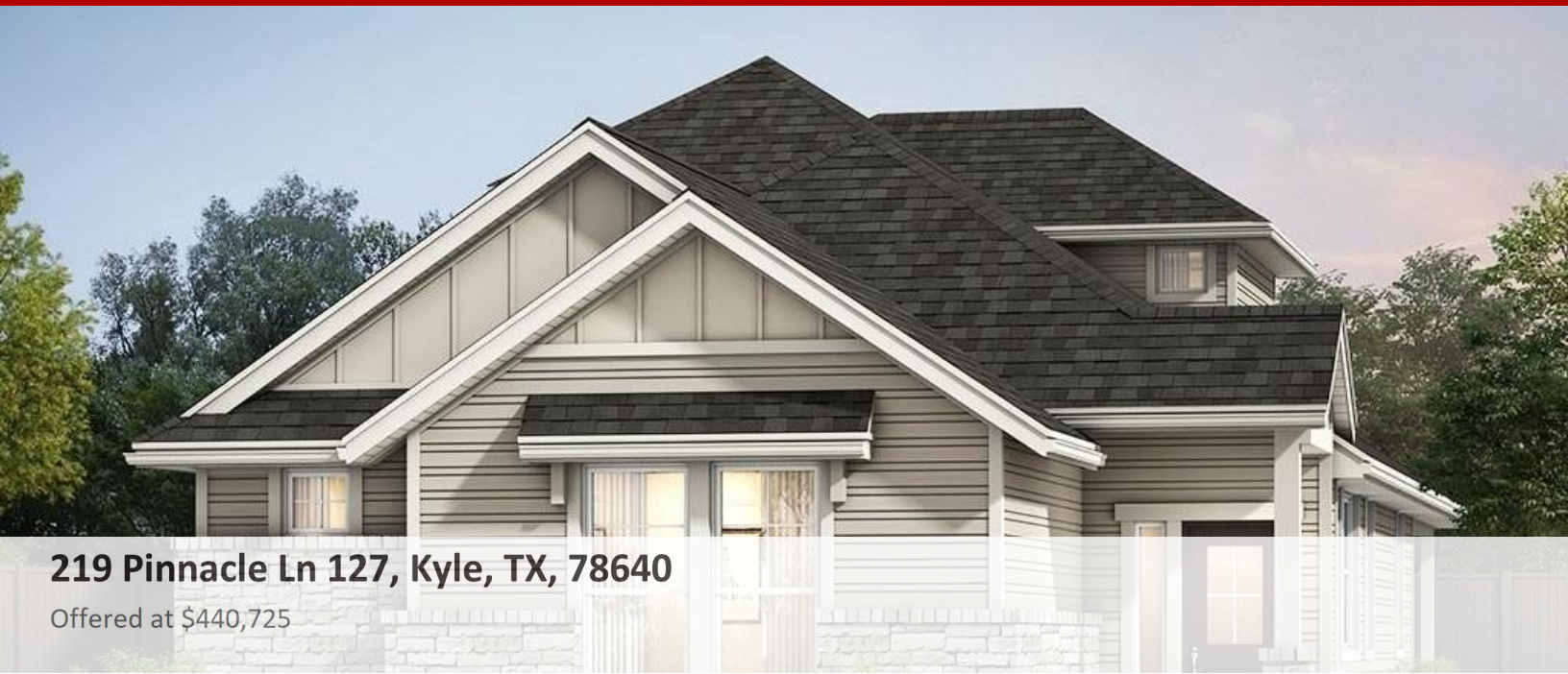

219 Pinnacle Ln 127, Kyle, TX, 78640

Offered at \$440,725

MLS#5435898 Built by Avi Homes, Canyon floor plan elevation B. 4bd, 3ba, 2 car garage, single story detached condominium. Come check out the new 1880 at Plum Creek neighborhood for care free living featuring lock and leave living with a choice of duplex style A and B condominium units or detached stand alone condominiums. Landscaping and irrigation all included in HOA fees. Situated in a rapidly growing Uptown Plum Creek development area, just minutes from highly regarded Hays ISD schools, Many attractions near by like shopping, coffee, golf, movies and more. Close to hospitals and health services as well.

4 Bedrooms

3 Bathrooms

1,921 sqft

Built: 2022

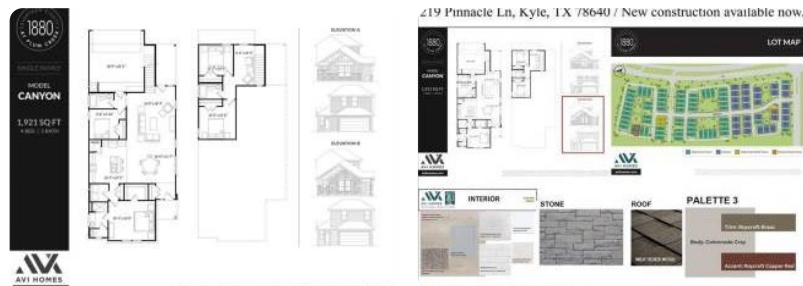

Scan above on mobile device
for directions to this listing

Assist2Sell Buyer's & Seller's Preferred Realty
(512) 627-6990
dchance@assist2sell.com

Assist2Sell

All information deemed reliable but not guaranteed. If your property is currently listed this is not meant as a solicitation.
©2025 Assist2Sell.com - Licensed according to agreed upon terms and conditions. This listing is courtesy of Keller Williams Realty International



<https://assist2sell.com/listing/219-pinnacle-ln-127-kyle-tx-78640/3yd-kw-12224332>