

Land/Lot - Wildomar, CA

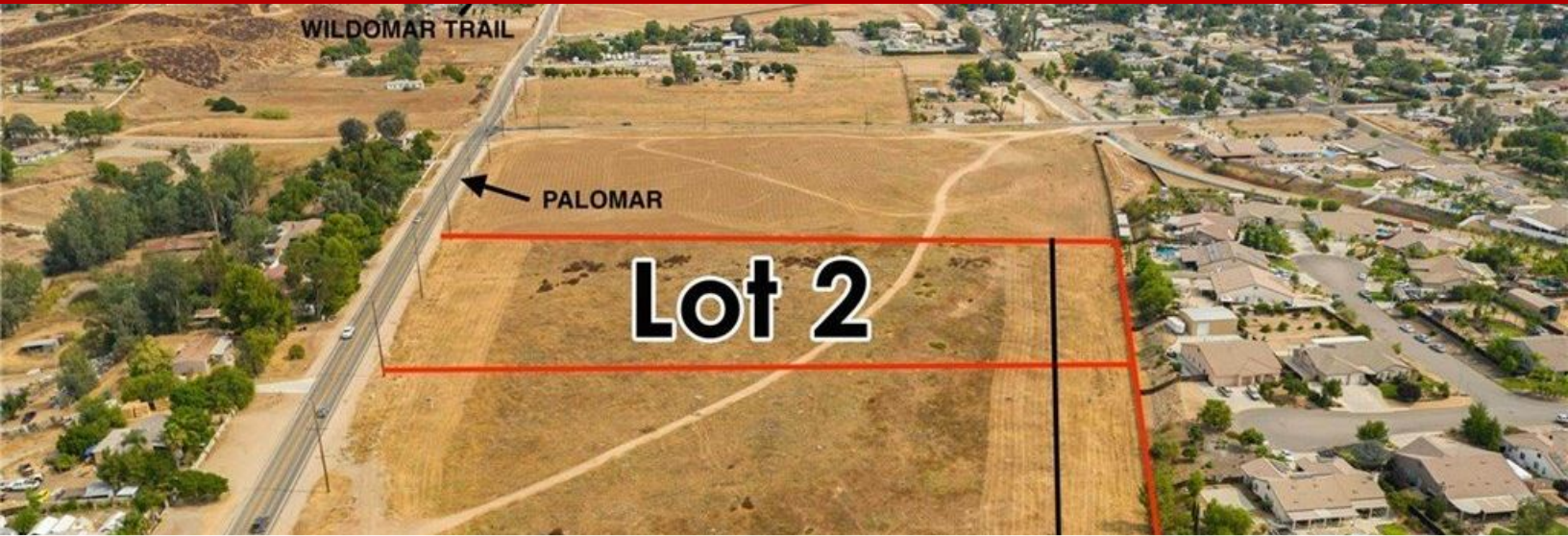

2 Palomar Street, Wildomar, CA, 92594

Offered at \$1,302,882

5.19 Acres..total. The front parcel is 4.78 acres of Commercial. Heart of Wildomar, Palomar Rd Frontage. Earth Quake Studies done and available. Flat to gentle property with paved road frontage Power and Phone near, and in the path of progress There are two almost identically sized properties available here side to side. so if client need 10 acres they can both be purchased together

0 Bedrooms
0 Bathrooms
Unknown sqft sqft
5.19 acres (lot size)
Built: Unknown year



Scan above on mobile device
for directions to this listing

Assist2Sell
vip@assist2sell.com



All information deemed reliable but not guaranteed. If your property is currently listed this is not meant as a solicitation.
©2025 Assist2Sell.com - Licensed according to agreed upon terms and conditions. This listing is courtesy of Realty ONE Group Southwest

