

Acreage (more than 10 acres) - Richland, MS

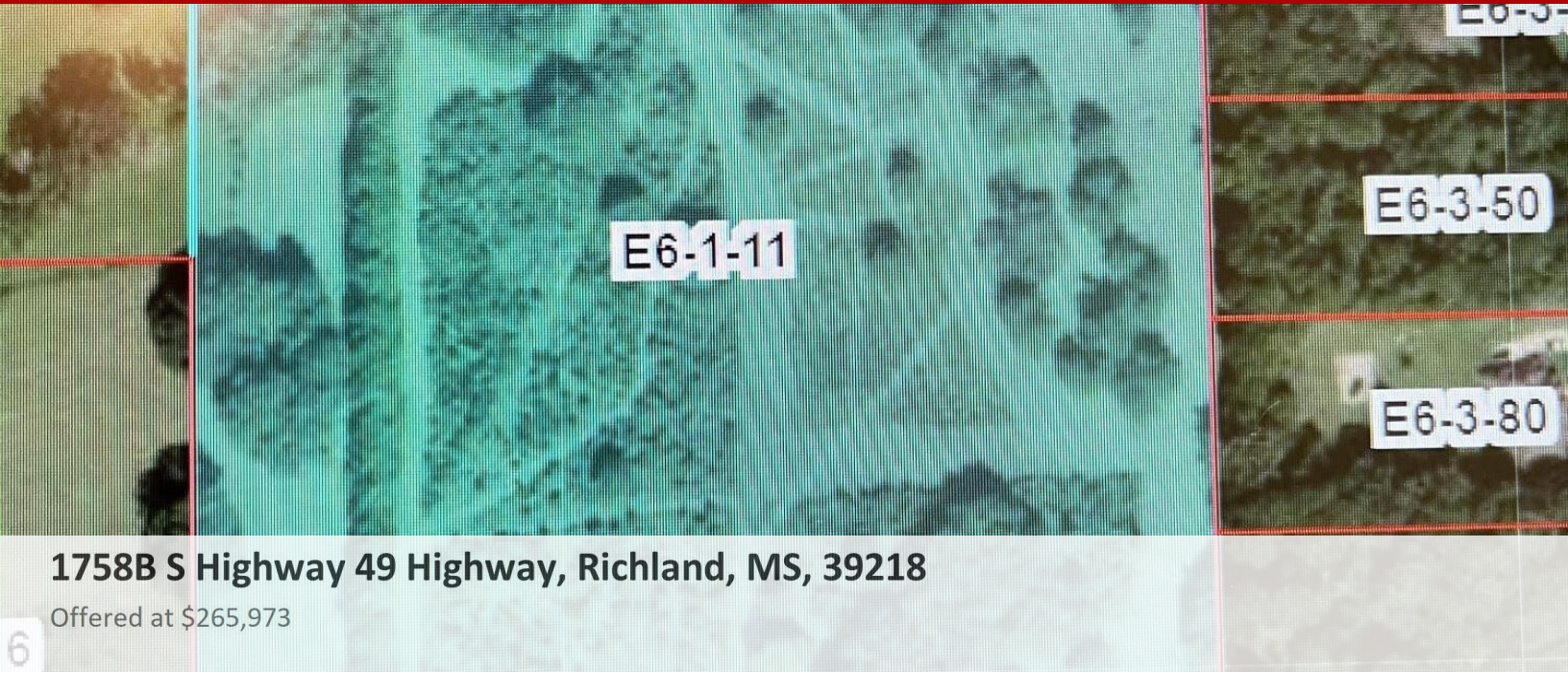

Beautiful Property - Approx 26 acres of Residential Land Located in Rankin County, Richland Area. Previously a Homesite with horses and livestock. Great location with quick access to Hwy 49 and other interstates. Room for development, Residential homesite, Recreational site, or a gorgeous place to keep horses. Additional Land Available. Easement access from 49S.

0 Bedrooms
0 Bathrooms
Unknown sqft sqft
26.6 acre (lot size)
Built: Unknown year

Assist2Sell

No other photos
Available

Assist2Sell

No other photos
Available

Assist2Sell

No other photos
Available

Assist2Sell

No other photos
Available

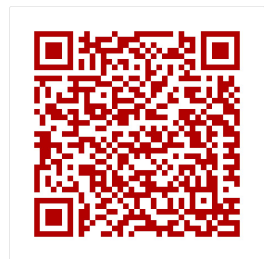

Scan above on mobile device
for directions to this listing

Assist2Sell
vip@assist2sell.com

Assist2Sell

All information deemed reliable but not guaranteed. If your property is currently listed this is not meant as a solicitation.
©2025 Assist2Sell.com - Licensed according to agreed upon terms and conditions. This listing is courtesy of Three Rivers Real Estate



<https://assist2sell.com/listing/1758b-s-highway-49-highway-richland-ms-39218/3yd-mgcmlsms-4030433>