

Residential - Pullman, WA

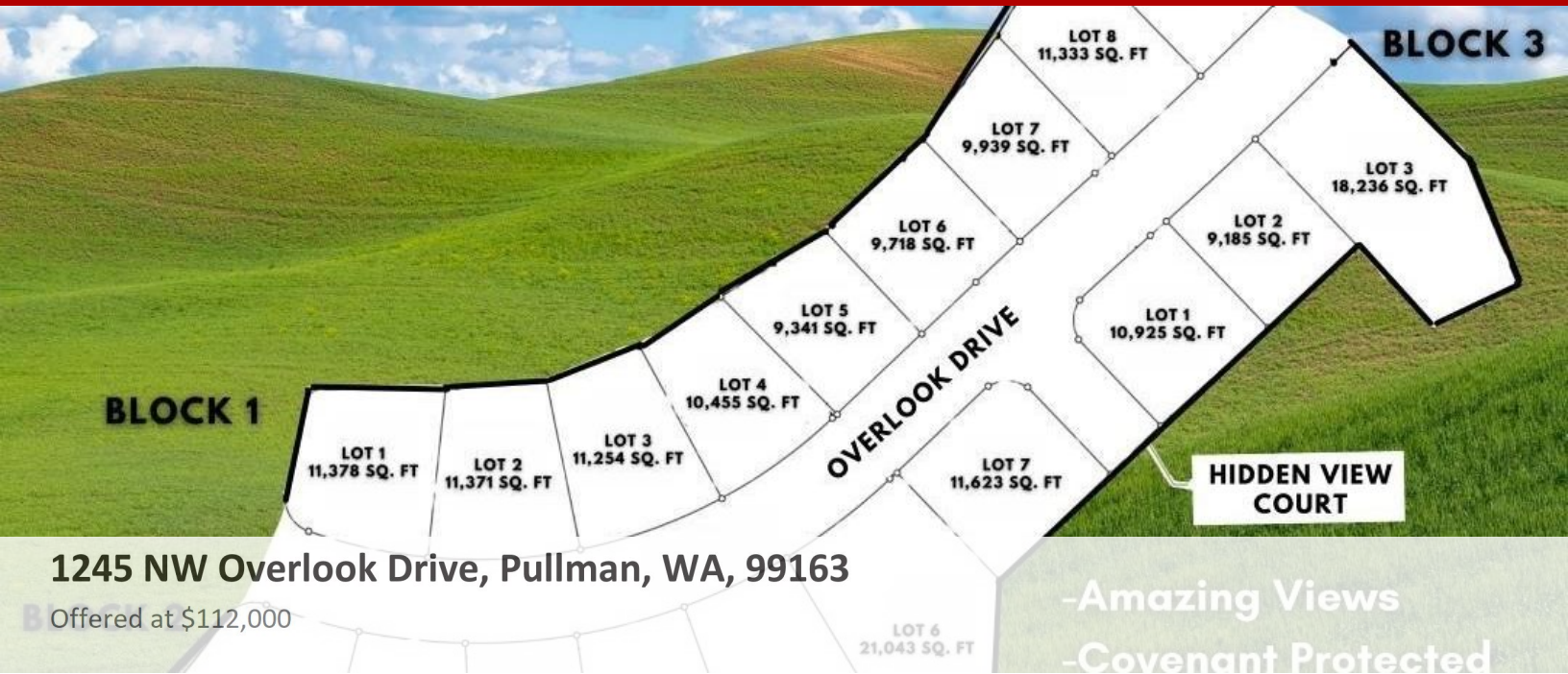

1245 NW Overlook Drive, Pullman, WA, 99163

Offered at \$112,000

MLS# 257812 Welcome to Paradise Hills! Pullmans newest development with amazing territorial views in an upscale neighborhood. Large lot sizes, covenant protected, and super location to nearby Kamiak Elementary School, Pullman High School and SEL. Reserve your lot today. Fiber Optics coming soon./Mick Nazerali/206-794-7860/Coldwell Banker Tomlinson - Pullman//

0 Bedrooms
0 Bathrooms
Unknown sqft sqft
0.29 acre (lot size)
Built: Unknown year



Scan above on mobile device
for directions to this listing

Assist2Sell
vip@assist2sell.com



All information deemed reliable but not guaranteed. If your property is currently listed this is not meant as a solicitation.
©2025 Assist2Sell.com - Licensed according to agreed upon terms and conditions. This listing is courtesy of Coldwell Banker Tomlinson Associates



<https://assist2sell.com/listing/1245-nw-overlook-drive-pullman-wa-99163/3yd-pacmlswa-257812>