

# Unimproved Land - Blue Ridge, TX

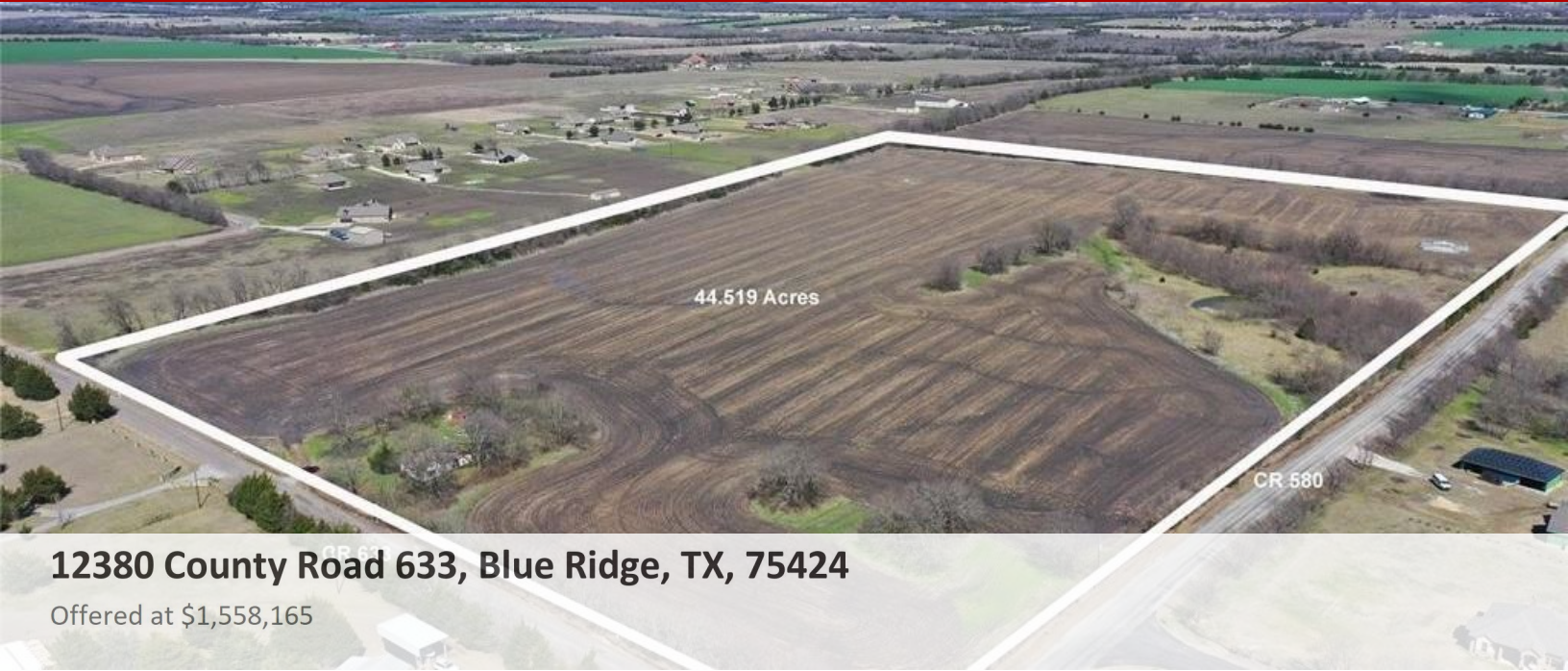

12380 County Road 633, Blue Ridge, TX, 75424

Offered at \$1,558,165

Fantastic 44 acre property with road frontage on two sides. Perfect for development and only two miles from the proposed loop and 14 miles from Hwy 380. No flood plain per FEMA maps. House on property has no value.

0 Bedrooms
0 Bathrooms
Unknown sqft sqft
44.34 acre (lot size)
Built: 1940



Scan above on mobile device  
for directions to this listing

Assist2Sell  
vip@assist2sell.com



All information deemed reliable but not guaranteed. If your property is currently listed this is not meant as a solicitation.  
©2025 Assist2Sell.com - Licensed according to agreed upon terms and conditions. This listing is courtesy of Farmersville Real Estate Company

