

Commercial - Manchester, NJ

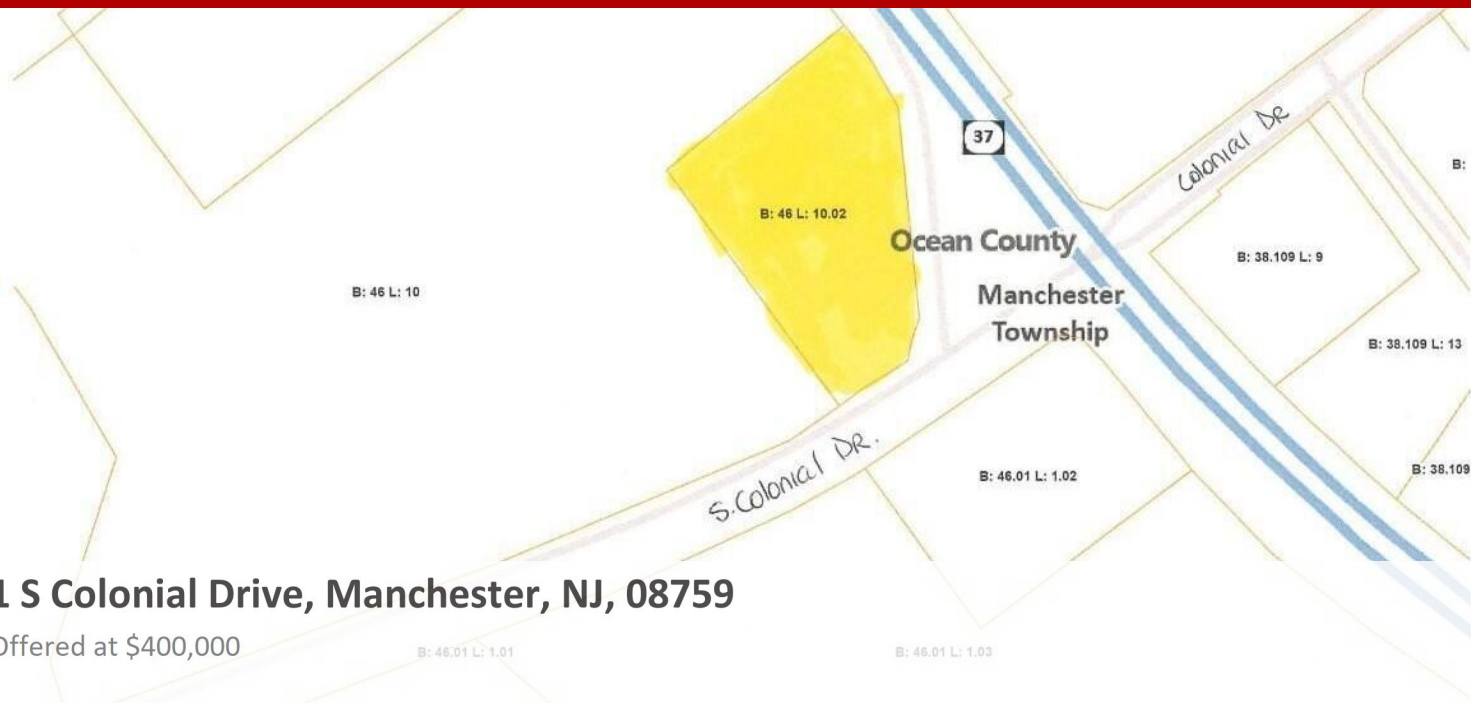

1 S Colonial Drive, Manchester, NJ, 08759

Offered at \$400,000

2.11 Acre Development Site for sale on the corner of Route 37 and South Colonial Dr in Manchester. The lot is across the street from the Manchester Municipal Building and located in the TC Zone. Also located in close proximity to Leisure Village West. Some permitted uses include retail, office, and medical. See the full list attached in documents.

0 Bedrooms
0 Bathrooms
Unknown sqft sqft
2.11 acre (lot size)
Built: Unknown year

Assist2Sell

No other photos
Available

Assist2Sell

No other photos
Available

Assist2Sell

No other photos
Available

Assist2Sell

No other photos
Available



Scan above on mobile device
for directions to this listing

Assist2Sell Buyers & Sellers Advantage Realty
(609) 242-3350
hb@assist2sell.com

Assist2Sell

All information deemed reliable but not guaranteed. If your property is currently listed this is not meant as a solicitation.

©2025 Assist2Sell.com - Licensed according to agreed upon terms and conditions. This listing is courtesy of Crossroads Realty Inc-WH



<https://assist2sell.com/listing/1-s-colonial-drive-manchester-nj-08759/3yd-momlsnj-22201628>