

# Land/Lot - Modjeska Canyon, CA

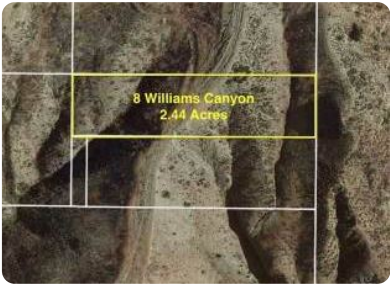

Nearly 15 Acres of beautiful picturesque, rarely offered, ocean view, vacant land in the unspoiled hills between Williams Canyon and Modjeska Canyon, Orange County! Consisting of 4 separate parcels that are available to purchase separately as well. Modjeska Canyon is West of the I-133 and the I-241 Freeways. Just North of Foothill Ranch, Lake Forest, Rancho Santa Margarita and Mission Viejo. Southwest of Irvine Lake and Close to Santiago Canyon Park. Easy commute for weekend visits to your very own paradise! Quiet, serene, and extremely private! This 2,000' elevation, lot far above all the hustle and bustle and tainted air, has Magnificent Views of Orange County, all the way out to Catalina Island. Spectacular parcel for the hiker, nature lover, bird watcher, painter, photographer and more! Own a special piece of heaven! Great addition to your families future investment portfolio! Must include this unique property! Unbelievable! R-A zoning. Remote parcel has no utilities. This land has gorgeous rolling slopes with some fairly flat areas for your building. Coordinates to the property are 33°43.236'N, 117°37.651'W. Best way to access your property is by hiking up just over one mile from Mark Road trail head off Modjeska Canyon Road. Great family and friends adventure! Prospective buyers to do your own due diligence. Extraordinary and Unique parcel OPPORTUNITY in highly demanded Orange County, California!

0 Bedrooms
0 Bathrooms
Unknown sqft sqft
15 acres (lot size)
Built: Unknown year



Scan above on mobile device  
for directions to this listing

Assist2Sell  
vip@assist2sell.com



All information deemed reliable but not guaranteed. If your property is currently listed this is not meant as a solicitation.  
©2026 Assist2Sell.com - Licensed according to agreed upon terms and conditions. This listing is courtesy of Re/Max One

