

Commercial - DOVER, DE

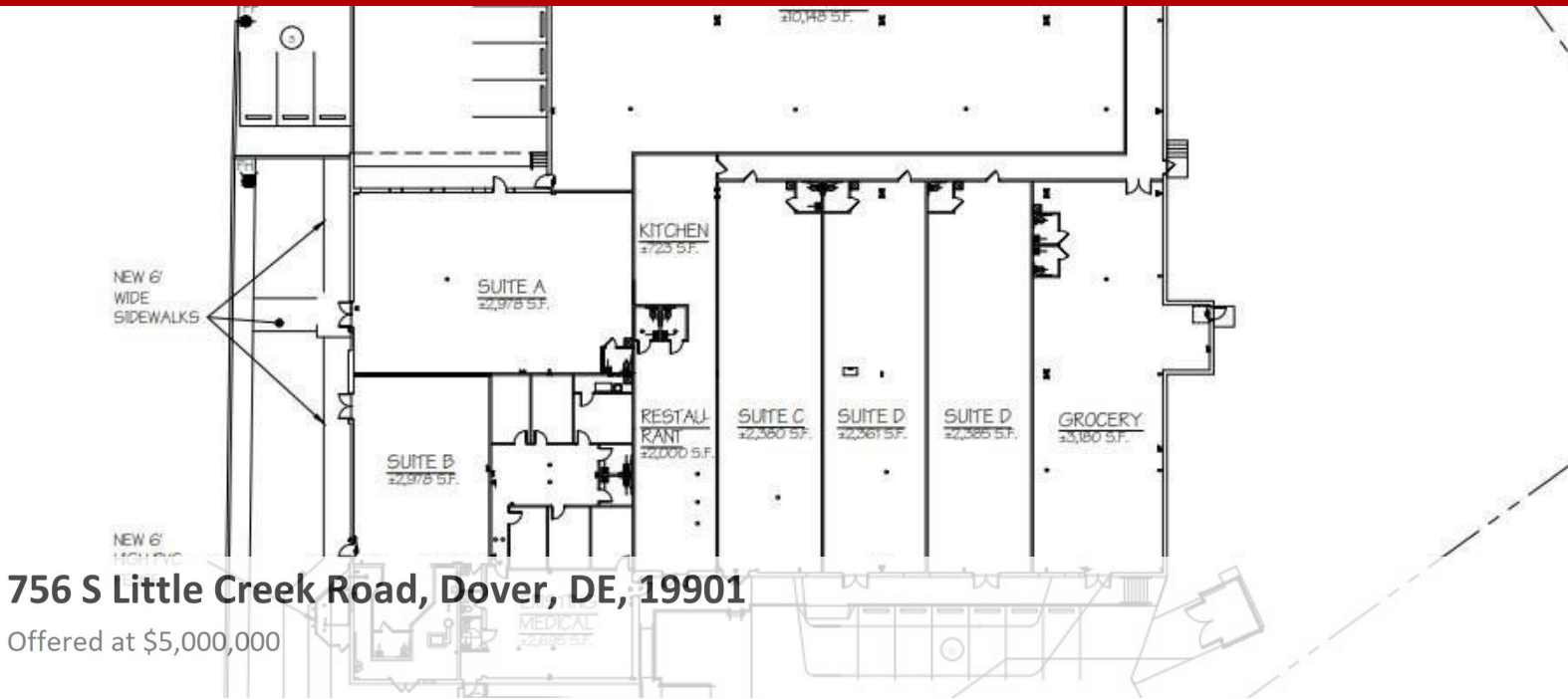

756 S Little Creek Road, Dover, DE, 19901

Offered at \$5,000,000

Up for sale is the newly renovated 33,000 +/- sqft Dover Depot Property.? Zoned C-4, Highway Commercial in the city of Dover, DE.? The shopping center is 100% leased with three 8+ year NNN tenants and 3% annual COL increases.? All leases begin at the conclusion of the renovations ETA Q1 2022.? Within sight of a busy lighted intersection leading to Rt113, Rt13, and a Rt1 Interchange this site is ideally located for easy access to all parts of the state.?

0 Bedrooms
0 Bathrooms
Unknown sqft sqft
3.41 acre (lot size)
Built: 1958

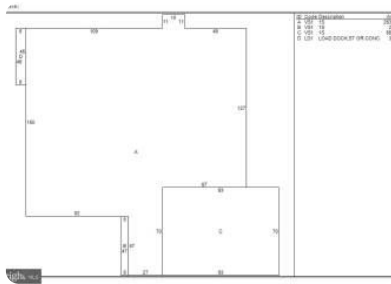

Scan above on mobile device
for directions to this listing

Assist2Sell
vip@assist2sell.com

Assist2Sell

All information deemed reliable but not guaranteed. If your property is currently listed this is not meant as a solicitation.
©2026 Assist2Sell.com - Licensed according to agreed upon terms and conditions. This listing is courtesy of The Moving Experience
Delaware Inc.



<http://assist2sell.com/listing/756-s-little-creek-road-dover-de-19901/3yd-trendpa-dekt2005724>