

Farmhouse/National Folk, Detached - SABILLASVILLE, MD



14715 Herman Hauver Road, Sabillasville, MD, 21780

Offered at \$649,927

New Construction Modern Farmhouse Rancher with 360-degree Mountain Views. One level, open floor plan with partially finished walk out basement. Level property with room for detached garage, firepit, pool, 4H animals, etc... NO HOA, NO Covenants, and NO Shared Driveway. Construction completed by end of 2022. Signage on the property, blueprints and plat available to download. Don't miss this rare opportunity to live as you wish in a private mountain setting. Call for an appointment today.

4 Bedrooms

3 Bathrooms

2,011 sqft

2.08 acre (lot size)

Built: 2022

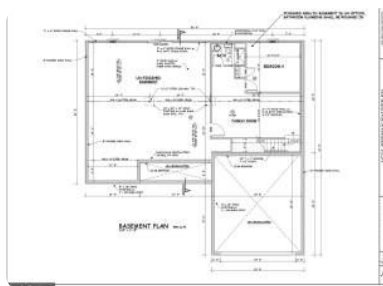
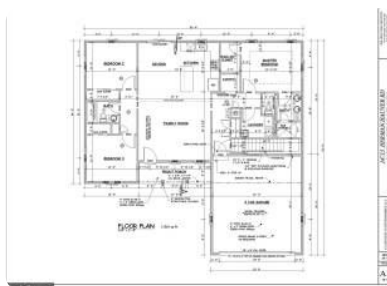

Scan above on mobile device
for directions to this listing

Assist2Sell
vip@assist2sell.com

Assist2Sell

All information deemed reliable but not guaranteed. If your property is currently listed this is not meant as a solicitation.

©2026 Assist2Sell.com - Licensed according to agreed upon terms and conditions. This listing is courtesy of Real Estate Teams, LLC



<http://assist2sell.com/listing/14715-herman-hauver-road-sabillasville-md-21780/3yd-trendpa-mdfr2016866>