

Residential - Maypearl, TX



140 Ozro Road, Maypearl, TX, 76064

Offered at \$799,900

Byrum Ranch is a new custom neighborhood located in Maypearl Tx. We are bringing the modern ranch style to Ellis County. The neighborhood consists of one-acre minimum lots, county taxes, access to a lake, walking trails, and beautiful sunset views. Byrum Ranch is located 9 minutes from Highway 67 making it the perfect location for anyone wanting to live in the country while having access to the surrounding cities. We have nine lots left along Ozro Rd that are ready to build TODAY! The remainder of phase one will be available for building in 2023. Canyon Creek Custom Homes is locally owned and operated in Ellis County Tx. This inventory property allows custom quality with a quicker close! CALL US today to get more information on the neighborhood and lets start making your dreams come to life!

3 Bedrooms

2 Bathrooms

2,766 sqft

1 acre (lot size)

Built: 2022

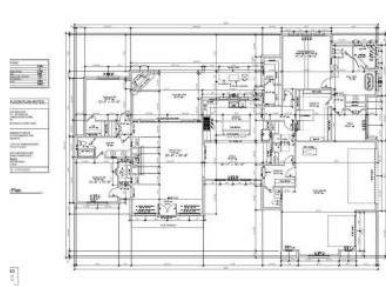

Scan above on mobile device
for directions to this listing

Assist2Sell
vip@assist2sell.com

Assist2Sell

All information deemed reliable but not guaranteed. If your property is currently listed this is not meant as a solicitation.
©2026 Assist2Sell.com - Licensed according to agreed upon terms and conditions. This listing is courtesy of NextHome, Inc



<http://assist2sell.com/listing/140-ozro-road-maypearl-tx-76064/3yd-nexthome-210972>